

NOTE

1. Section Cut A-A는 정면도를 +Z Axis 방향에서 바라본 Parting Surface로 절단한 단면도임.
2. Inlet와 Outlet의 관지름 (Inlet: $\phi 65$, Outlet: $\phi 55$)을 Parameter화 하여 단면적의 적합성을 검토하시요.
 $3000\text{mm}^2 < \text{Inlet} < 4000\text{mm}^2 \rightarrow \text{OK}$
 $2000\text{mm}^2 < \text{Outlet} < 3000\text{mm}^2 \rightarrow \text{OK}$

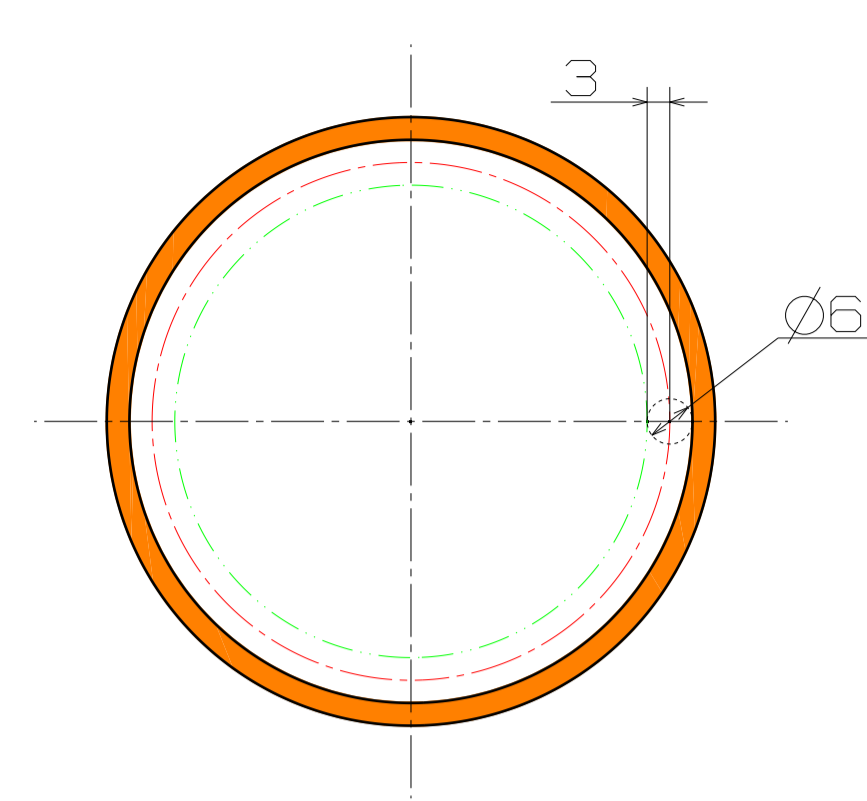

Section Cut B-B

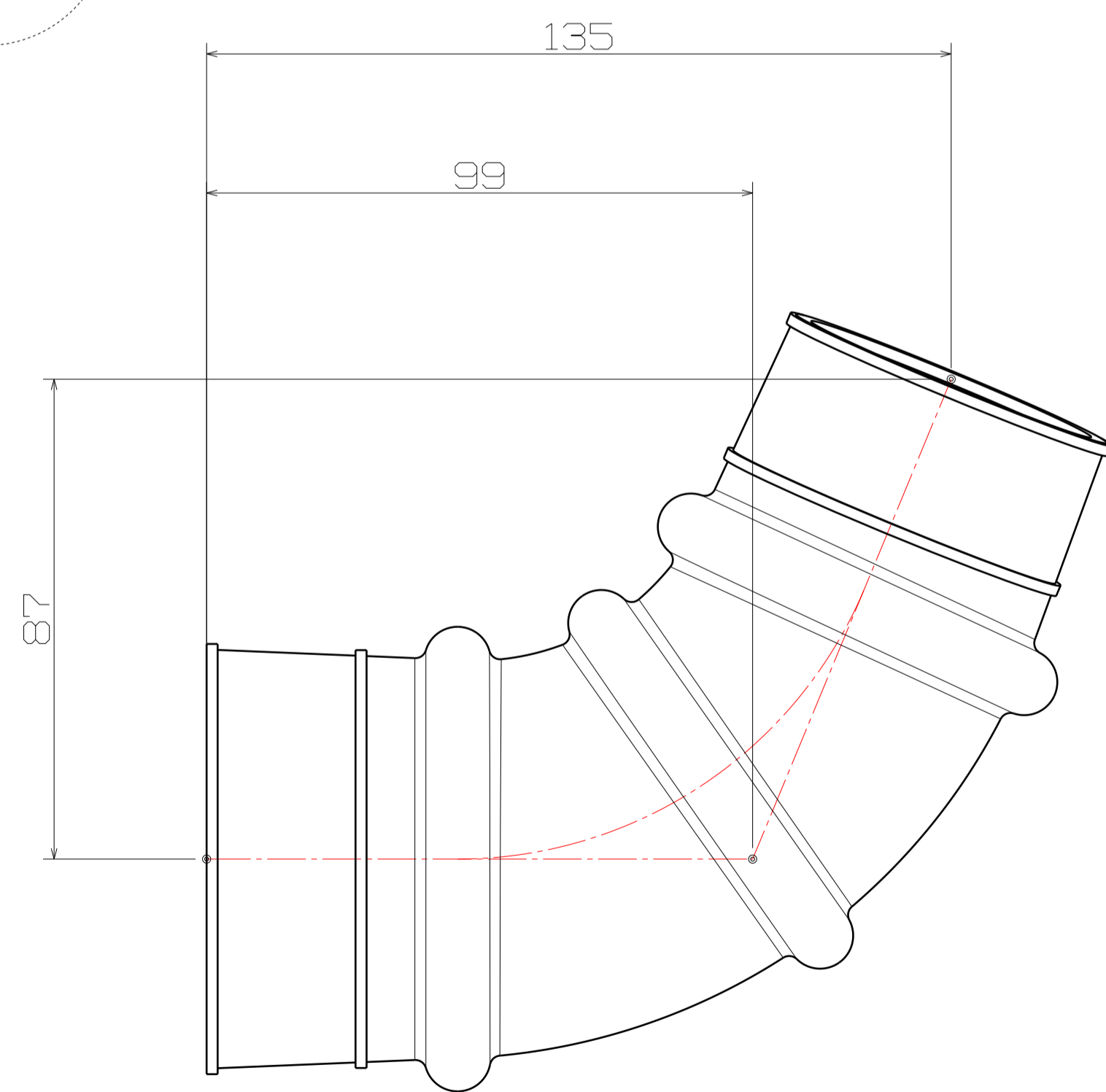
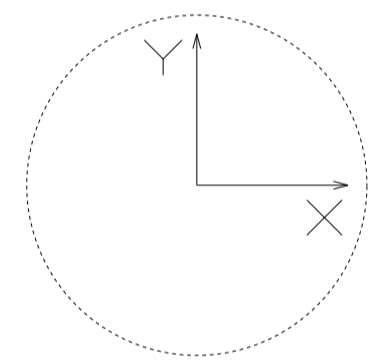
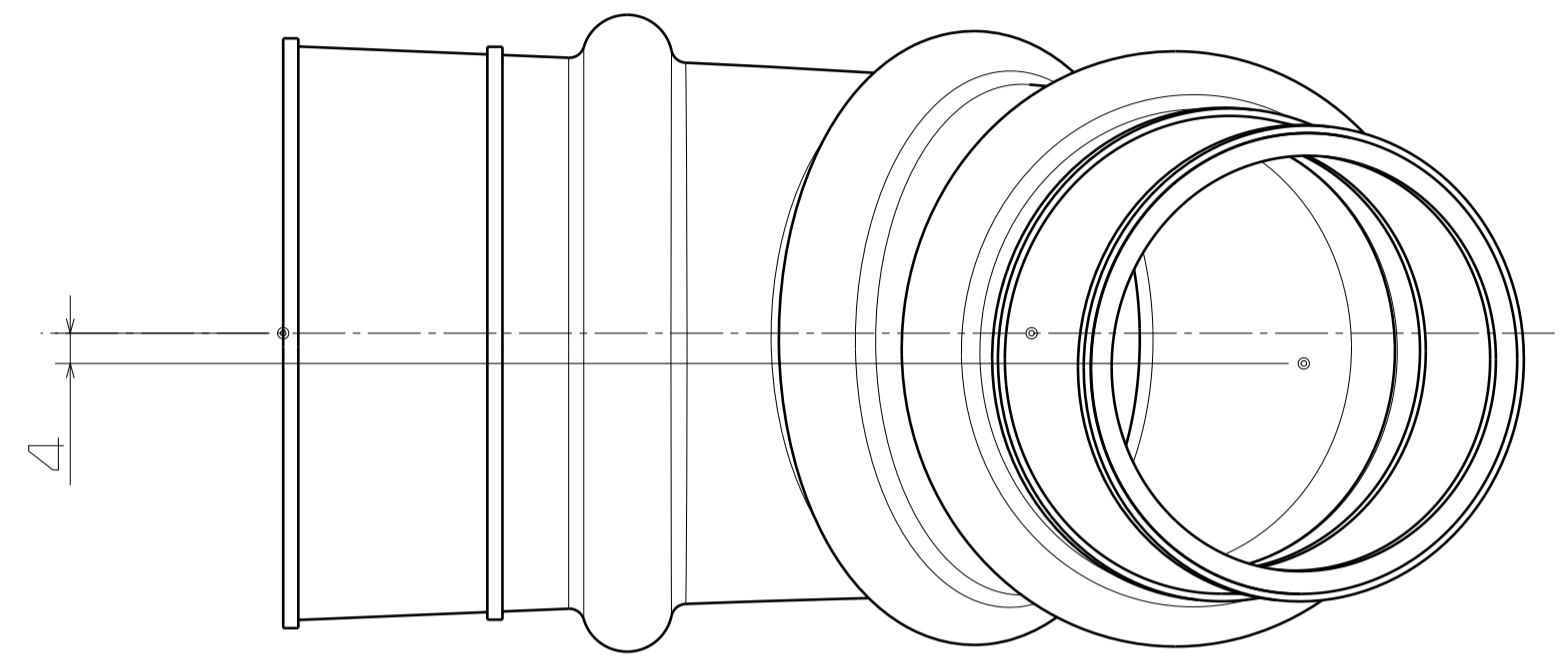
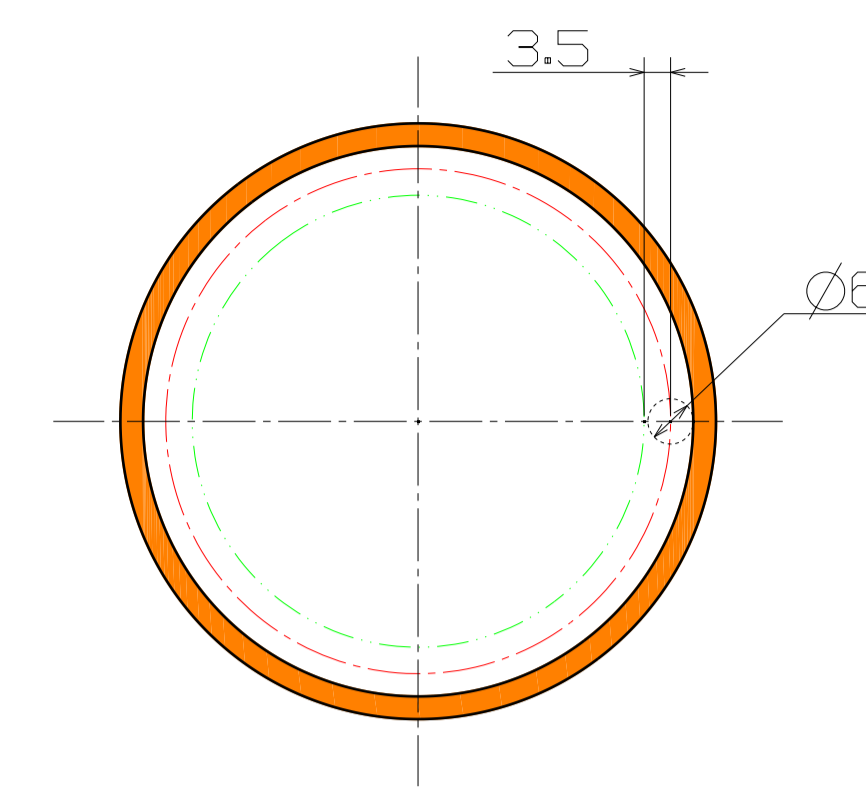

Section Cut C-C

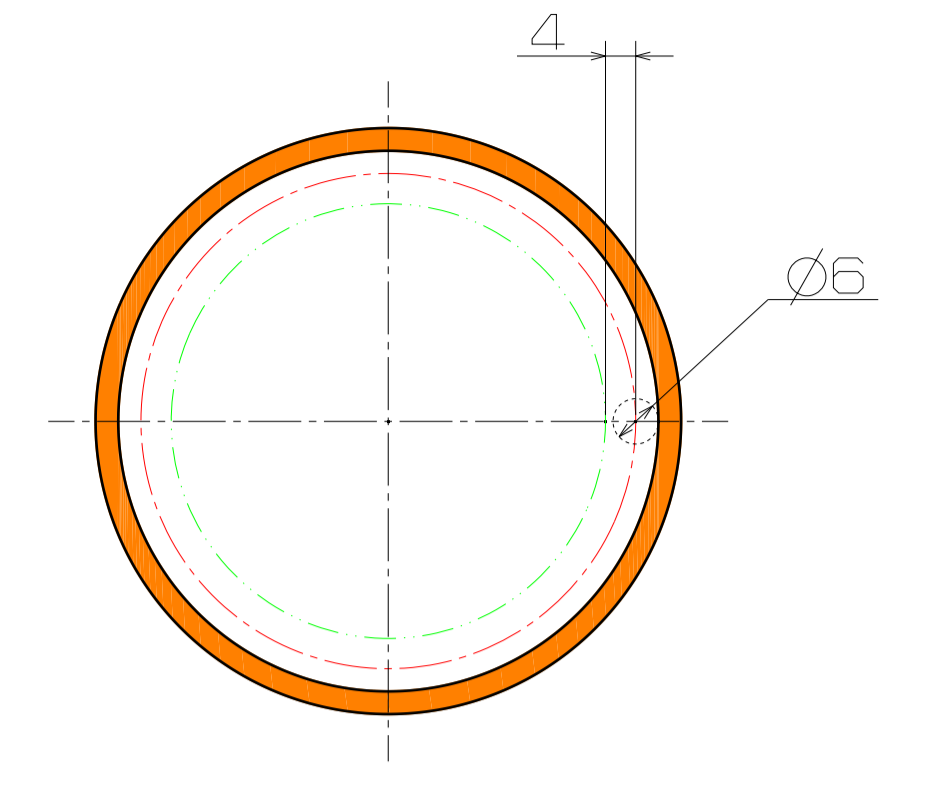

Section Cut D-D

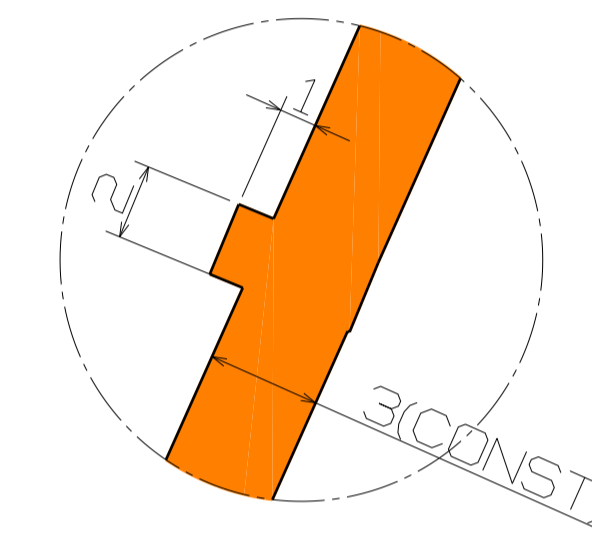

Detail View E
Scale 5:1

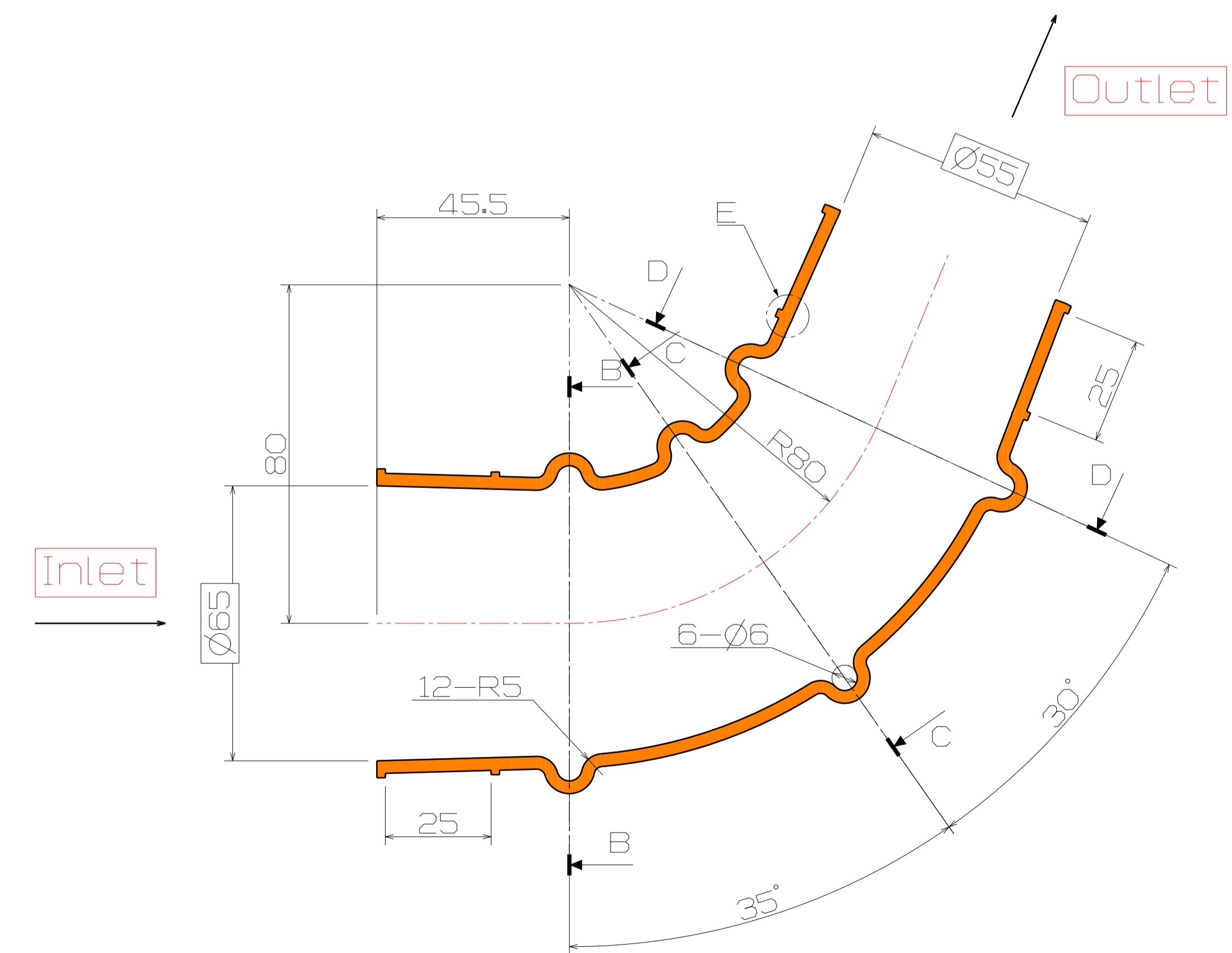

Section Cut A-A